

# CLOSING REGULATOR INSTALLATION INSTRUCTIONS FOR RC/STD

## DOUBLE LEAF UNIVER/REVER DOORS

**NINZ** s.p.a.  
Corso Trento, 2/A  
I-38061 ALA (TN) / ITALIA

**A023-GB**  
5001122/2 - 06/07

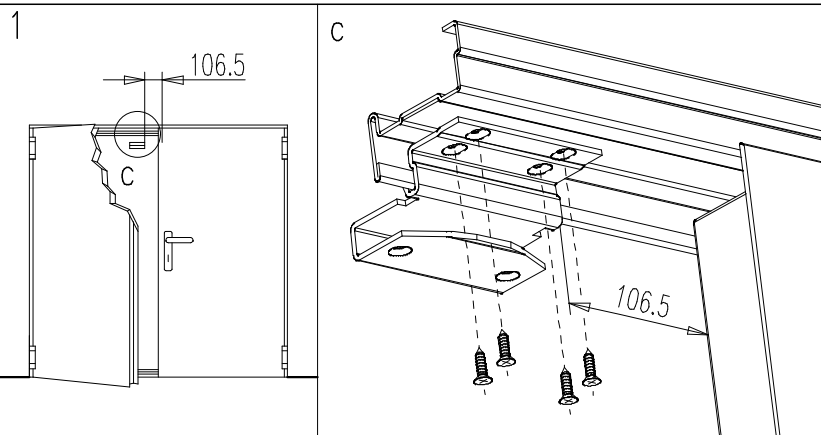

### INSTALLATION INSTRUCTIONS FOR CLOSING REGULATOR

1. Fix the bracket on to the frame using the corresponding pre-drilled holes with four 4,2x16 self tapping screws; in the case of the Rever frame use a 3,25mm diameter drill bit in the position indicated in the drawing 1.
2. Fix the closing regulator to the bracket with 2 M5 x 16 screws.
3. Regulate the opening of the arm by means of the appropriate internal screw on the regulator housing; the angle formed between the arm and the principal door leaf must be 90°.

### CONTENT OF THE BOX

- No.1 closing regulator
- No.1 installation bracket on frame Univer or Rever
- No.4 screws TPS 4,2 x 16 self tapping
- No.2 screws TPS M5 x 16
- No.1 installation instructions

### WARNING

The safety characteristics of this product are of fundamental importance for conformity with EN 1158. With the exception of those described in these instructions modifications of any kind are prohibited. The closing regulator is highly resistant to corrosion; nevertheless, we recommend protecting it from external atmospheric agents. Installation must be carried out paying careful attention to the relevant instructions and drawings. For correct installation it is necessary to install all the components included in the delivery. Any maintenance or repair work carried out on the system must be carried out by specialised personnel.

### MAINTENANCE INSTRUCTIONS

At least every 6 months the following operation must be carried out: check the functionality of the closing regulator; test the open position (90° angle against the principal door leaf); lubricate the internal hinging of the arm.

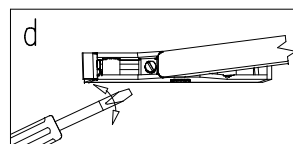
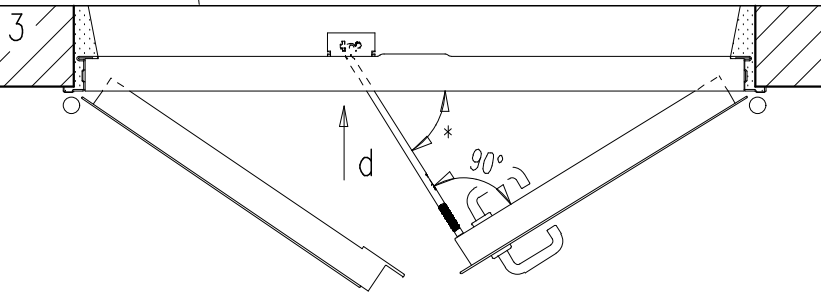
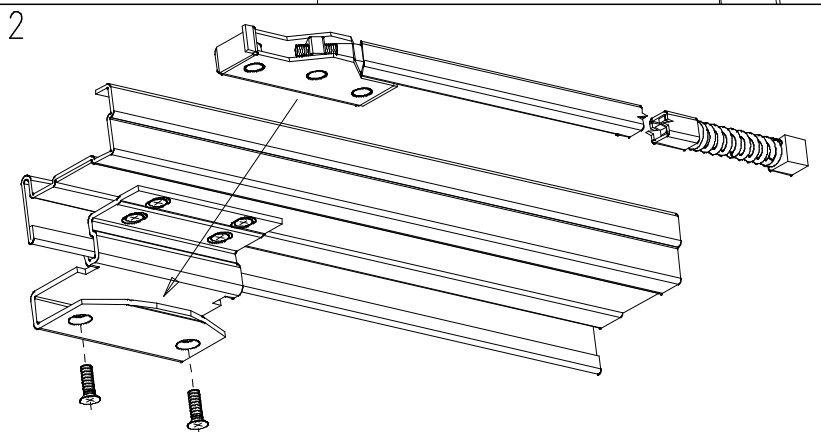

\*.....Adjustable opening angle

## INSTRUCTIONS FOR THE REGULATION OF THE GUIDE ARM (IF PRESENT)

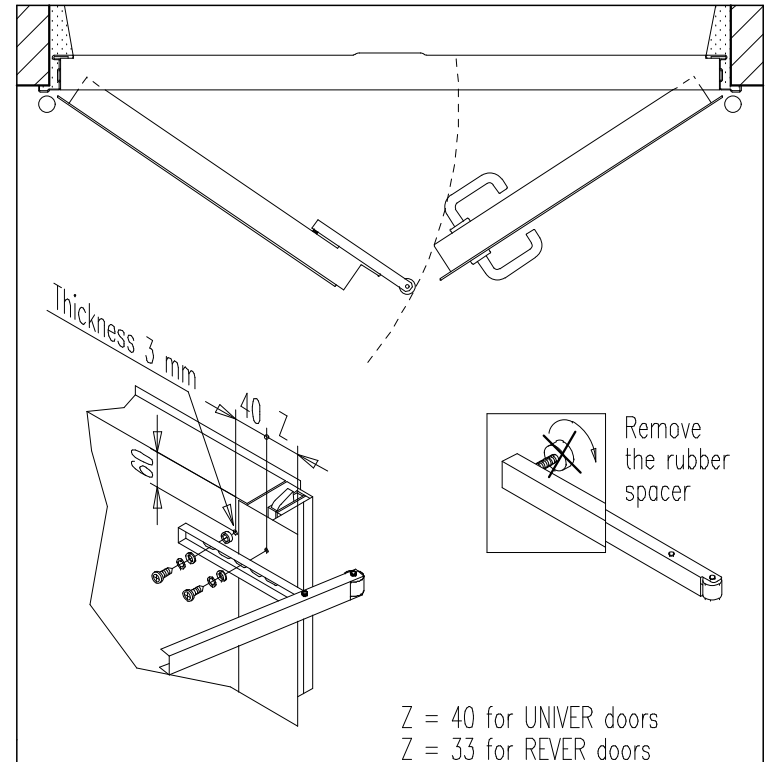

## INSTRUCTIONS FOR THE INSTALLATION OF THE GUIDE ARM

1. Drill two holes using a 4,2mm diameter drill bit, 60mm from the edge of the central assembly (Z = 40mm for Univer doors and Z = 33mm for Rever doors) as shown in the drawing.
2. Remove the guide arm rubber spacer and use the washer to fix the arm and the nut as a spacer.
3. Fix the guide arm with 2 self tapping screws 5,5 x 13 at the height of the first and third hole, between the first and third hole insert the nut included in delivery as a spacer.
4. If necessary adjust the horizontal position of the arm.

<b>CE</b>	model RC/STD	NINZ SPA Ala (TN) ITALY	06
0425-1153	EN 1158:2003	3 5 $\frac{5}{3}$	1 1 4