

## COMPLEMENTARY INSTRUCTION FOR THE FOLLOWING PANIC BARS KIT:

Code	Description	Instr. nr.
4204307.001	KIT panic bar replac. EXUS LP A PROGET	A085 + A166
4204307.002	KIT panic bar replac. EXUS LA A PROGET	A094 + A166
4204307.003	KIT panic bar replac. EXUS LX A PROGET	A100 + A166
4204307.004	KIT panic bar replac. TWIST A PROGET	A106 + A166
4204307.005	KIT panic bar replac. SLASH A PROGET	A115 + A166
4204307.006	KIT panic bar replac. SLASH AR PROGET	A115 + A166
4204307.007	KIT panic bar rep. SLASH ALU A PROGET	A124 + A166
4204307.008	KIT panic bar rep. SLASH ALU AR PROGET	A124 + A166
4204307.009	KIT panic bar rep. SLASH INOX A PROGET	A130 + A166
4204307.010	KIT panic bar rep. SLASH INOX AR PROGET	A130 + A166

## VARIATIONS OF THE PACKAGE CONTENTS

Position	pcs.	Description
40, 41, 42	01	Upper rod with extension and pin
43, 44	01	Rods-lock top device with screw
45	01	Upper rod strike box
46, 47	01	Lower rod with pin and extension
-	01	Instructions for panic bars replacing not CE marked

## ATTENTION

-  Before the intervention, is recommended to check that the inactive (secondary) leaf of PROGET door is provided with one "CISA" marked lock and a rods-lock top device is top mounted identical as at pos. 43 depicted of the drawing below.  
If this correspond is possible to proceed with panic bar replacement, otherwise it is advisable to contact your Dealer for a proper kit request.
- This instruction integrates with that specifies of the panic bar KIT, in particular as regards the application of the following components: lock, rods, rods-lock top device and upper rod strike box. Follow the indications on the back of this instruction for the replacement of above-mentioned components.
- The following instructions do not involve variations to the door. All KIT components are perfectly interchangeable with existing ones on the door. The producer declines each responsibility in case of changes that are not described in these instructions.

## IMPORTANT

- Installation should be carried out by qualified personnel only and in strict conformity with the instructions supplied below.
-  All of the included components described herein must be positioned and mounted in conformity with the present document.

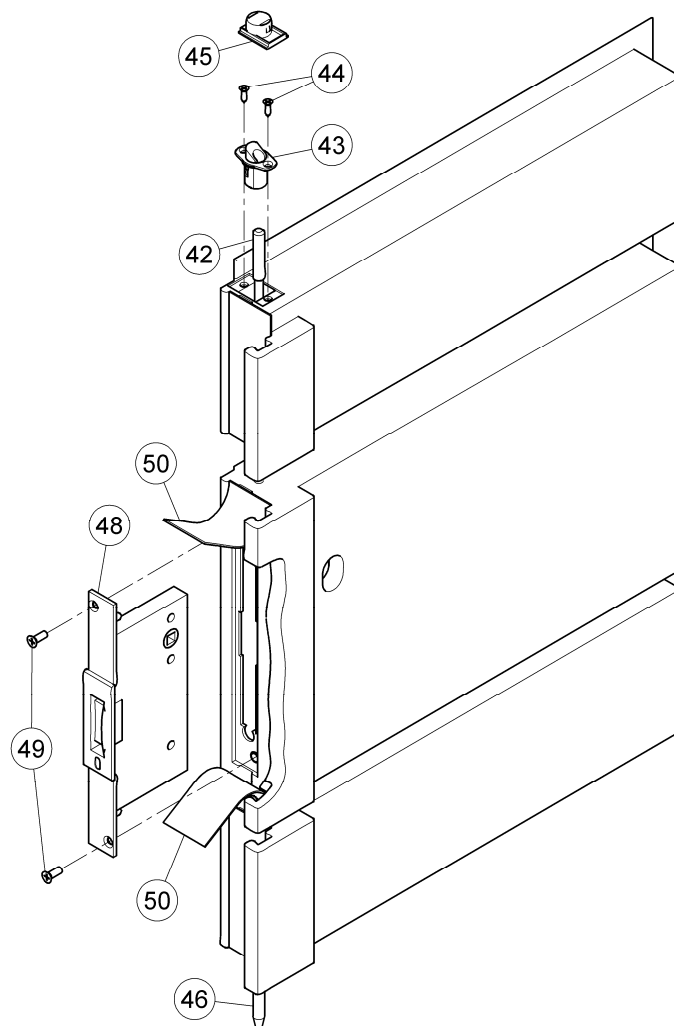

## REPLACEMENT PARTS

Position	Code	Description
40	3305024.001	Proget upper rod without pin
41	3305021	Upper rod extension with joint
42	3305026	Upper rod pin
43, 44	3105195	Rods-lock top device with screw
45	2401002	Upper rod strike box
46	3305025.001	Lower rod with pin
47	3305023	Lower rod extension with slot and joint
48	3201001.006	020 CISA panic safe lock inactive (secondary) leaf (Proget)

## INSTRUCTIONS FOR CORRECT DISASSEMBLY OF UNMARKED PANIC BAR

- Remove the inactive (secondary) leaf and place it horizontally on two trestles (operation necessary to remove the lower rod).
- First disassemble any panic bar components that are already present.
- Before to remove the panic safe lock (48), to measure and annotate the projection values of the upper and lower pin (A and C drawings).
- Remove the existing panic safe lock (48) by unscrewing the two frontal screws (49). For fire doors, first detach the heat-expanding seal (50) that is glued over the fastener screws.
- Remove the existing rods-lock top device (43), by unscrewing the two screws (44), then remove the rods-lock device and rods.
- Remove the upper rod strike box (45) from the top frame.
- Given the projection values of the upper and lower pin previously annotated, adjust the new rods in way that, once assembled, they protrude of 14,5 mm (A and C drawings). Example: if the length of the previous rod was 17 mm, the new rod will have 2,5 mm less than the previous. If necessary, adding the extension (41) at the upper rod (40), then adjust the length of the rods (40 and 46) by cutting the tube so as shown in E drawing.
- Proceed to assembly the upper rod (40, 41, 42) and lower rod (46, 47) components, squash the tube above the overlapping joints, by creating two opposed of 180° incision that penetrate into the throat of the joint (D drawing). For this use, for example, the tip of a hammer or a chisel. Finally, verify that the rods are straight, straighten it if deformed.

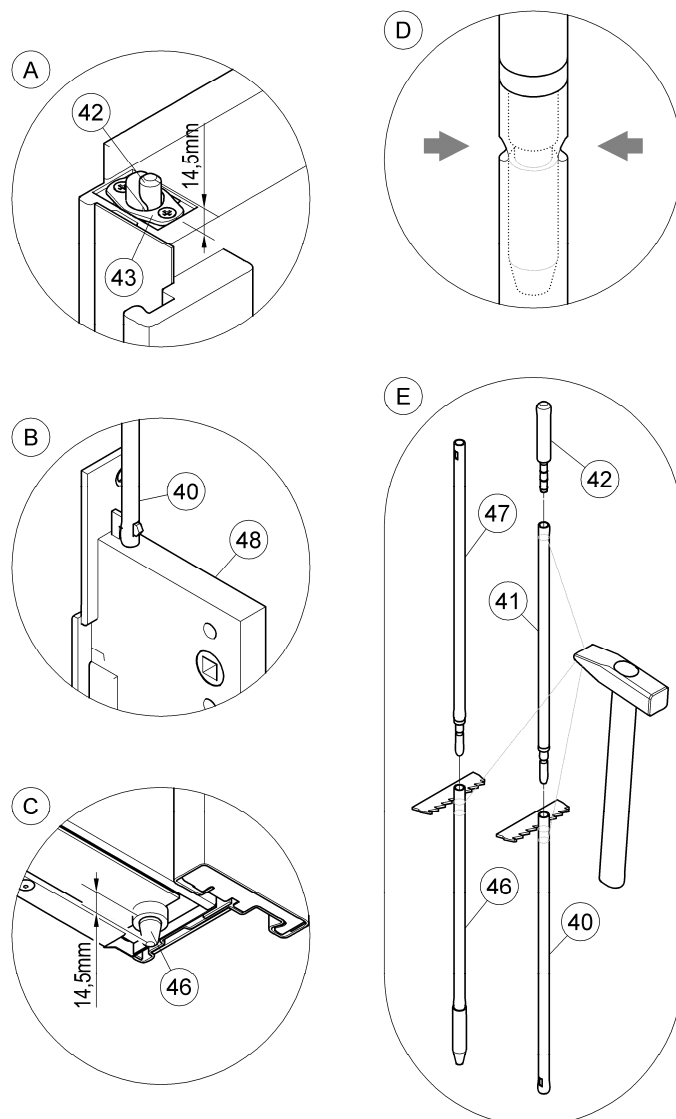

## INSTALLATION

- Apply the new rods-lock top device (43) from the KIT and fasten it with the two screws (44) so as represented in A drawing.
- Apply the new upper rod strike box(45) from the KIT, onto top frame.

-  - Attach the new panic safe lock (48), making sure to center the slot of the upper rod (40 - B drawing) and lower (47) rods. The operation should be carried out with great care, making sure not to ruin or displace any of the components inside the panic safe lock housing. Attention: the square slot onto panic safe lock should be turned towards the upper part of the door; re-use the two M6x16mm screws (49) for fastening. Ensure that the two rods are attached and can move freely.

- Continue the installation on following the instructions in PANIC BAR KIT included, from the next point to the one marked by symbol: 