

**1**

FM H  
 PTH  
 QPF

PT L = FM L - 74  
 PT L = FM L - 80  
 PT L = FM L - 74  
 PT H = FM H - 40

**2**

Posizionare  
 Position  
 Positionner  
 Situar

Forare il telaio  
 Drill the door frame  
 Percer le dormant  
 Taladrar el marco

Ø3mm

**3**

Rimuovere  
 Remove  
 Enlever  
 Remover

Forare il telaio  
 Drill the door frame  
 Percer le dormant  
 Taladrar el marco

Ø6,5mm

**4**

Avvitare  
 Screw  
 Visser  
 Atornillar

Ø4,8x25mm



✓

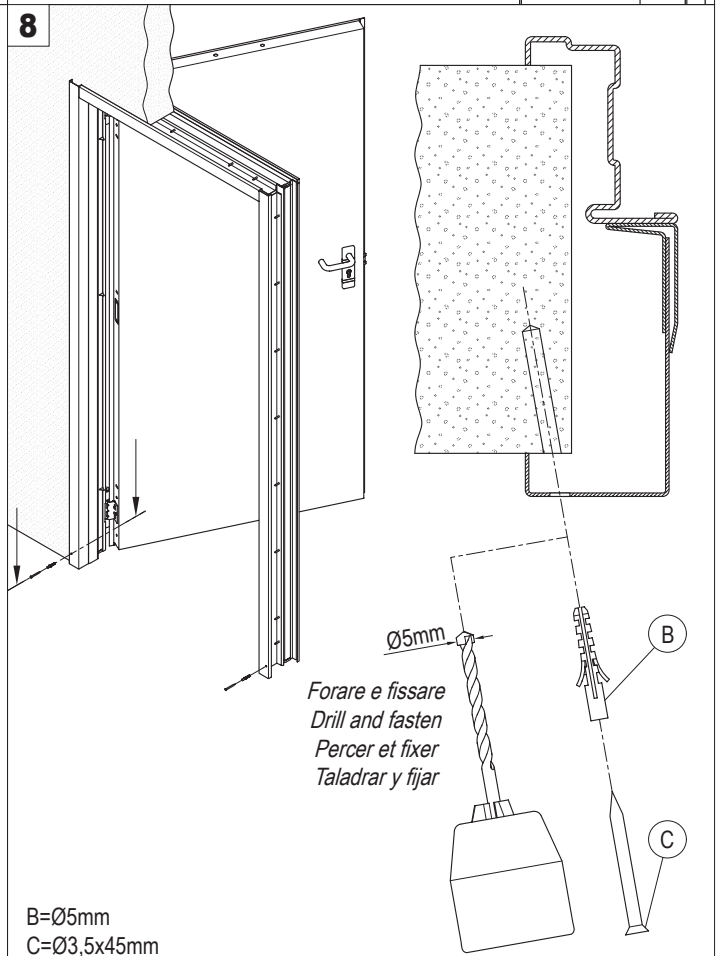
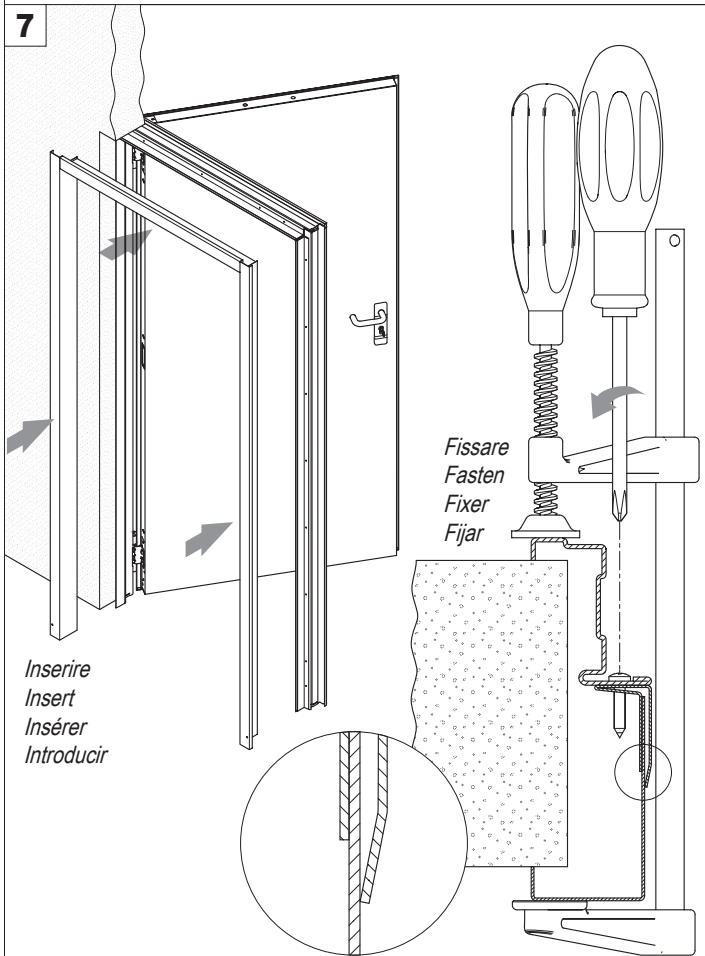
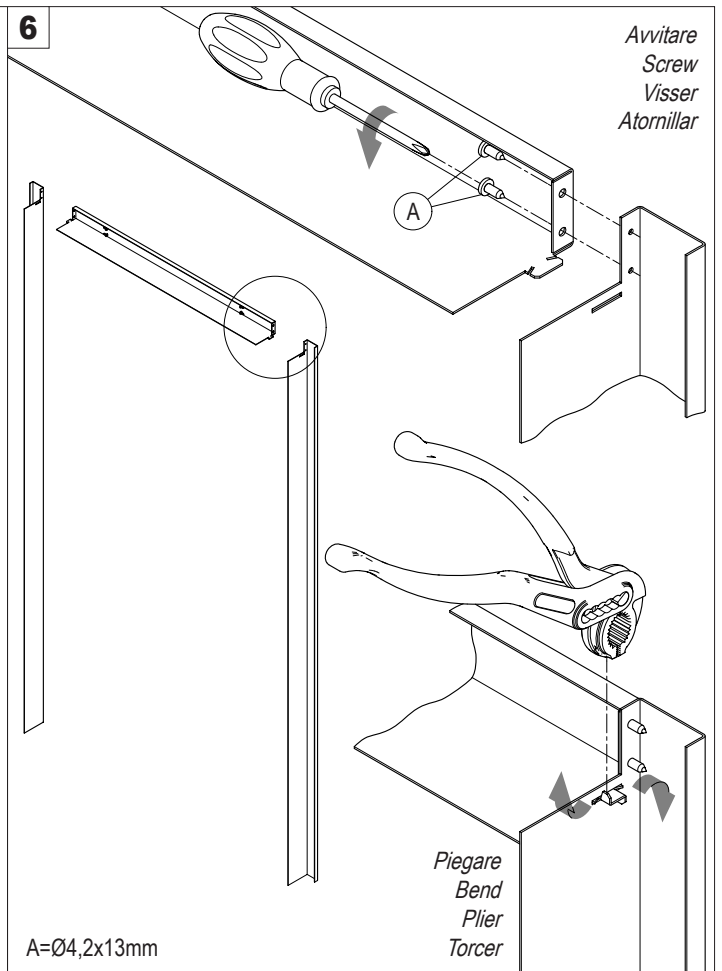
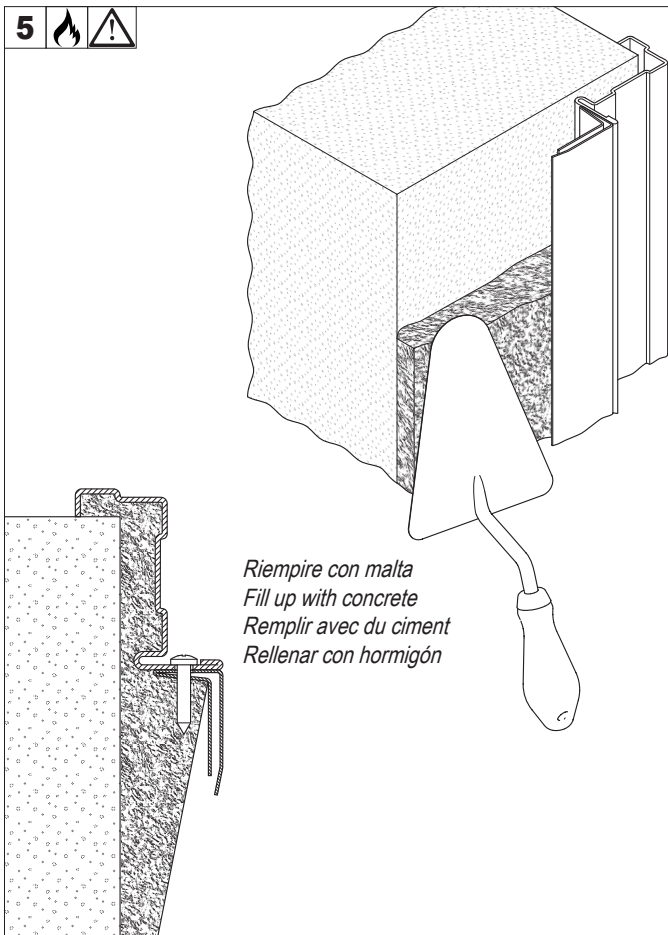

✗



✗



**SIMBOLOGIA-SYMBOLS-SYMBOLS-SÍMBOLOS**

-  Controllare - Check - Contrôler - Controlar
-  Un'anta - One leaf - Un vantail - Una hoja
-  Due ante - Two leaves - Deux vantaux - Dos hojas

-  Tagliafuoco - Fire rated - Coupe-feu - Cortafuego
-  Multiuso - Multipurpose - Multiusage - Multiuso
-  Quota pavim. - Floor level - Niveau sol - Nivel suelo

-  Corretto - Correct - Correcto
-  Errato - Wrong - Faux - Erróneo
-  Importante - Important